



KEY PLAN

PROJECT NAME:
 PLAN OF PROPOSED (G+8) NINE STORED RESIDENTIAL BUILDING (BLOCK-01) OF SHRI. RAMPRASAD ADHIKARY, S/O MR. PARIMAL ADHIKARI, (DEVELOPED BY SHREE BUILDERS) L.R. PLOT NO-208,209,210, L.R. KHATIAN NO-2219,907, J.L.NO-210, MOUZA-SANBANDA, P.S-BANKURA, DIST-BANKURA, WEST BENGAL-722180.

SCHEDULE OF DOOR & WINDOW:-

MARK	SIZE	DESCRIPTION
D1	1000X2100	FULLY PNL
D2	900X2100	FULLY PNL
D3	750X2100	FULLY PNL
W	1800X1200	SLIDING WINDOW
W1	1500X1200	SLIDING WINDOW
W2	1200X1200	SLIDING WINDOW
W3	1000X1200	SLIDING WINDOW
V3	VENTILATION FOR STAIR CASE.	
V4	600X450	UPVC MOVABLE VENTILATOR

- *** NOTES :-**
- ALL DIMENSIONS ARE IN M.M. AND ALL LEVEL ARE IN M.
 - WRITTEN DIMENSIONS MUST BE FOLLOWED
 - ALL EXTERNAL WALLS 250TH. & INTERNAL WALLS 125THK. UNLESS OTHERWISE MENTIONED.
 - ALL MASONRY WORKS ARE BOUNDED BY CEMENT MORTAR (1:6) & (1:4)
 - EXTERNAL PLASTER IS 25THK. & INTERNAL PLASTER IS 12MM.THK.
 - ALL CONC. GRADE IS M25 & AND GRADE OF STEEL FE-500
 - 250THK. BRICK WORK IN 1:6 MORTAR
 - 125THK. & 75THK. BRICK WORK IN 1:4 MORTAR
 - 150 WIDE SURFACE DRAIN SHOULD BE PROVIDED ALL ROUND THE BUILDING.
 - 25% OF THE BUILDING TO BE CONSTRUCTED USING FLY-ASH BRICKS

AREA CALCULATION:-

LAND AREA	PLINTH AREA	
	FLOOR	AREA (SQ.M.)
849.82 SQ. M.	GROUND FLOOR	445.96 SQ.M.
	FIRST FLOOR	474.93 SQ.M.
	SECOND FLOOR	474.93 SQ.M.
	THIRD FLOOR	474.93 SQ.M.
	FORTH FLOOR	474.93 SQ.M.
	FIFTH FLOOR	474.93 SQ.M.
	SIXTH FLOOR	474.93 SQ.M.
	SEVENTH FLOOR	474.93 SQ.M.
	EIGHT FLOOR	474.93 SQ.M.
TOTAL	4245.40 SQ.M.	

* NO. OF FLATS = 47
 * NO. OF CAR PARKING = 36

OFFICE USED:-

Sajeeb
 Assistant Engineer
 (P. & R.D.)
 Bankura Zilla Parishad

A.P.
 District Engineer
 Bankura Zilla Parishad

TITLE:

*SECTIONAL VIEW

DRAWN BY:

CHECKED BY:

SCALE: 1:100.
 REV.-00 DATE: 27.07.2022

SHEET NO:
 GIDS/BANKURA/BLOCK-01/-02/06

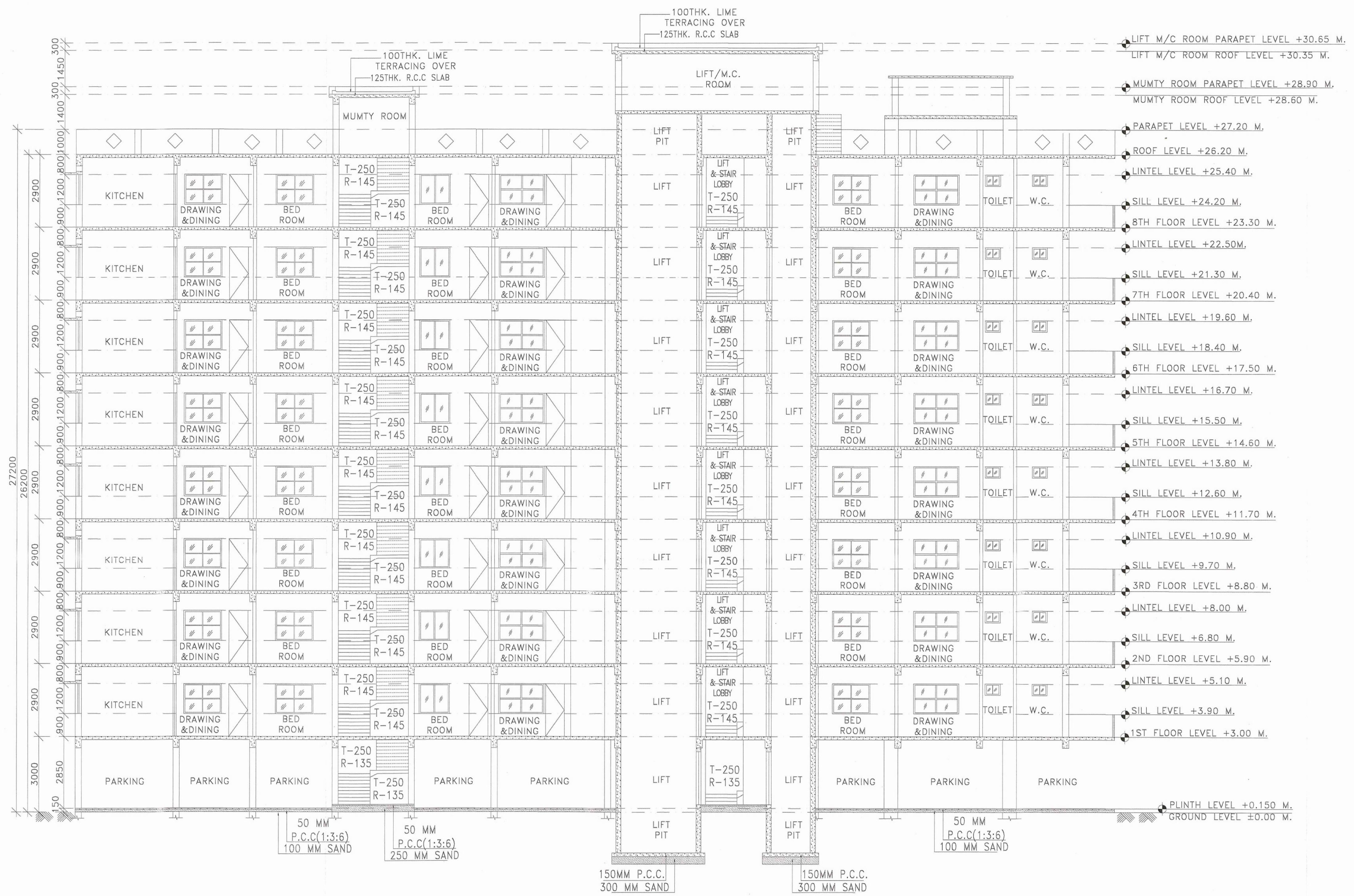

SECTION Y-Y'
 SCALE: 1:100

SIGNATURE OF ARCHITECT:
VAISHNAV K...
 CONSULTING ARCHITECT
 CAI/2018/101108

SIGNATURE OF STRUCTURAL ENGINEER:
Hrishabh Ghosh
 Structural Engineer
 Lic No.-LB.P.M/163/AMC-DMC/DP/165
 DCE, B-TECH

SIGNATURE OF GEO TECHNICAL ENGINEER:
MANOJ MAITI
 Geo-Technical Engineer
 Lic No.-LB.P.M/163/AMC-DMC/DP/165
 G.I.S., Durgapur

SIGNATURE OF DEVELOPER/OWNER:
 SHREE BUILDERS
 Kuntal Bhattacharya
 Partners

